

**ORDINANCE 19-OZ-27** amending the Zoning Ordinance and the Zoning Map of the City of Murfreesboro, Tennessee, as heretofore amended and as now in force and effect to zone approximately 11.01 acres along Florence Road as Planned Type Development (PRD) District (Shelton Crossing PRD) simultaneous with annexation; Alcorn Properties, LLC, applicant [2019-420].

**BE IT ORDAINED BY THE CITY COUNCIL OF THE CITY OF MURFREESBORO, TENNESSEE, AS FOLLOWS:**

SECTION 1. That the same having been heretofore recommended to the City Council by the City Planning Commission, the Zoning Ordinance and the Zoning Map of the City of Murfreesboro, Tennessee, as herein referred to, adopted and made a part of this Ordinance as heretofore amended and as now in force and effect, be and the same are hereby amended so as to zone the territory indicated on the attached map.

SECTION 2. That, from and after the effective date hereof, the area depicted on the attached map be zoned and approved as Planned Residential Development (PRD) District, as indicated thereon, and shall be subject to all the terms and provisions of said Ordinance applicable to such districts, the plans and specifications filed by the applicant, and the conditions and stipulations referenced in the minutes of the Planning Commission and City Council relating to this zoning request. The City Planning Commission is hereby authorized and directed to make such changes in and additions to said Zoning Map as may be necessary to show thereon that said area of the City is zoned as indicated on the attached map. This zoning change shall not affect the applicability of any overlay zone to the area.

SECTION 3. That this Ordinance shall take effect fifteen (15) days after its passage upon second and final reading, the public welfare and the welfare of the City requiring it.

Passed:

1<sup>st</sup> reading August 22, 2019

2<sup>nd</sup> reading September 19, 2019

  
Shane McFarland, Mayor

ATTEST:

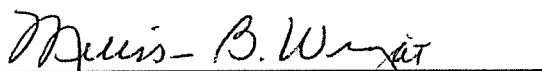
  
Melissa B. Wright  
City Recorder

APPROVED AS TO FORM:

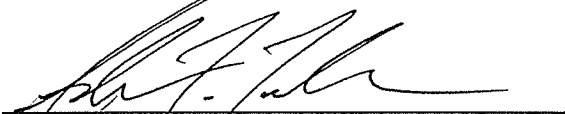
  
Adam F. Tucker  
City Attorney



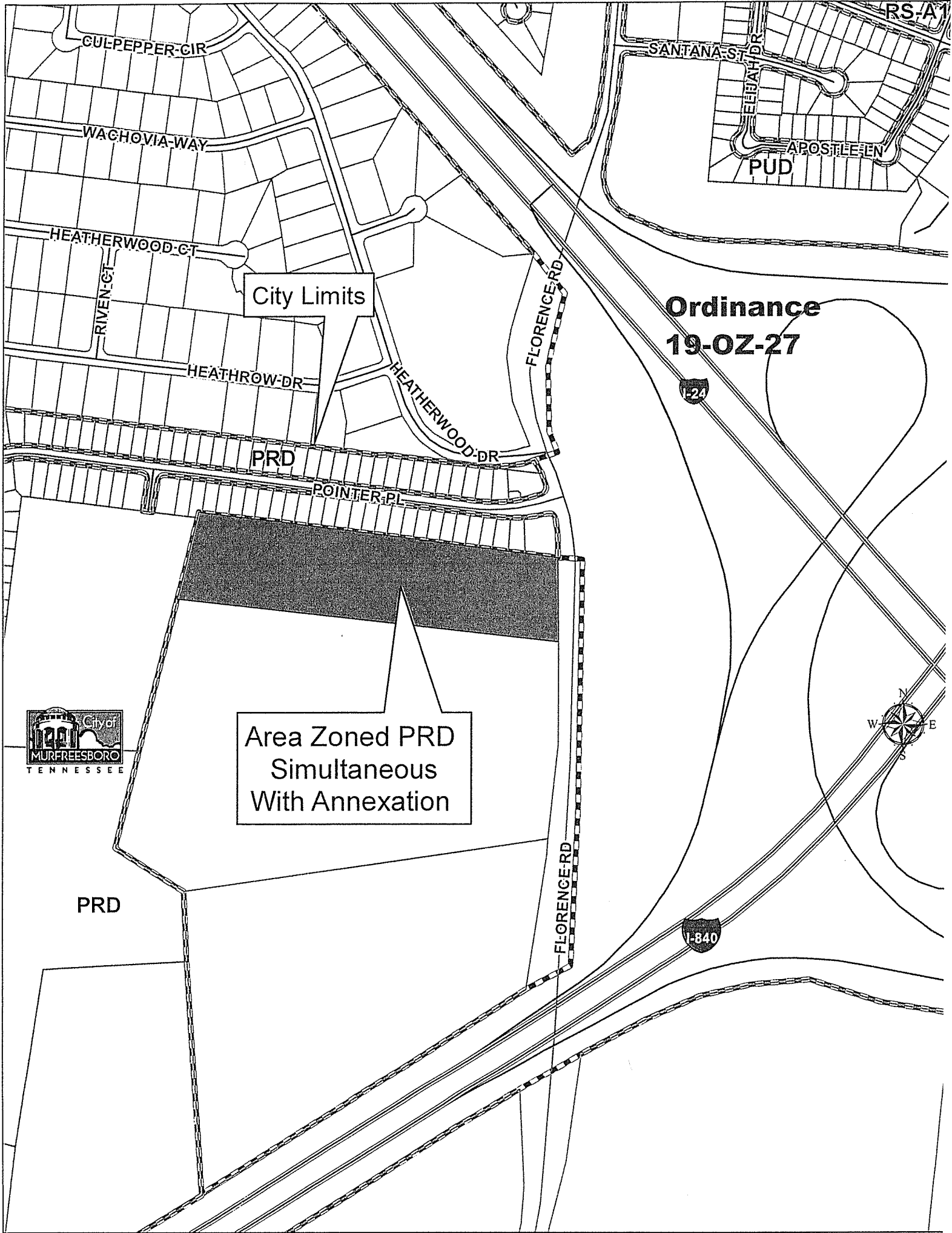

CULPEPPER CIR

WACHOVIA WAY

HEATHERWOOD CT

RIVEN CT

HEATHROW DR

HEATHERWOOD DR

FLORENCE RD

City Limits

PRD

POINTER PL

SANTANA ST

EBRAH DR

APOSTLE LN  
PUD

RS-A

Ordinance  
19-02-27



Area Zoned PRD  
Simultaneous  
With Annexation

PRD